

MORTAR JOINT

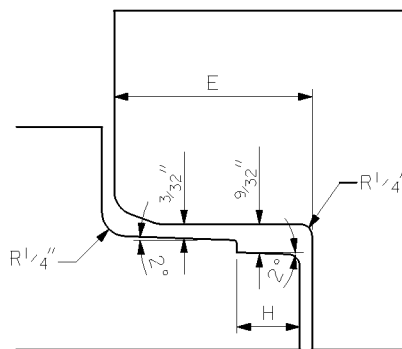

SINGLE OFFSET JOINT  
(ASTM C443)

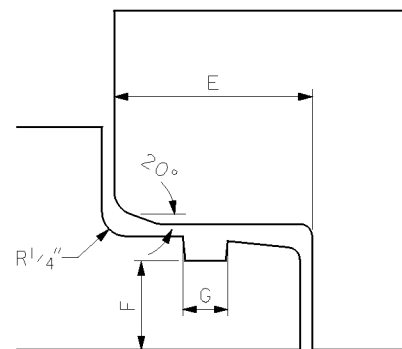

"O-RING" GASKET JOINT  
(ASTM C443/C361)

PIPE DIAMETER SIZE IN [mm]	WALL THICKNESS A IN (WALL)	OUTSIDE DIAMETER B	C	D	E	F	G	H	APPROX. WEIGHT LB./FT	WATERWAY AREA SQ. FT.
12" [300]	2 [B]	16	20	15.258	3 1/2	1.278	13/16	1 1/8	105	0.79
15" [375]	2 1/4 [B]	19 1/2	23 1/2	18.709	3 1/2	1.504	13/16	1 1/8	140	1.23
18" [450]	2 1/2 [B]	23	27	21.709	3 1/2	1.504	13/16	1 1/8	180	1.77
24" [650]	3 [B]	30	33	27.709	3 1/2	1.504	13/16	1 1/8	275	3.14
30" [750]	3 1/2 [B]	37	38 1/2	34.000	3 1/2	1.649	13/16	1 5/8	420	4.19
36" [900]	4 [B]	44	45 1/2	40.000	3 1/2	1.649	13/16	1 5/8	550	7.07

GENERAL NOTES:

- PIPE IS MANUFACTURED IN ACCORDANCE WITH APPLICABLE SPECIFICATIONS WITH REINFORCING STEEL AS REQUIRED BY ASTM C-76 (LATEST REVISION): "STANDARD SPECIFICATION FOR REINFORCED CONCRETE CULVERT, STORM DRAIN, AND SEWER PIPE". GASKET JOINTS ARE IN ACCORDANCE WITH AASHTO M-170 (LATEST REVISION) OR ASTM C-443 (LATEST REVISION): "STANDARD SPECIFICATION FOR JOINTS FOR CIRCULAR CONCRETE SEWER AND CONCRETE PIPE, USING RUBBER GASKETS".
- SEE SDCI REPRESENTATIVE FOR JOINT AVAILABILITY IN YOUR AREA.

**★**  
**SHERMANDIXIE**  
NASHVILLE, TN-KNOXVILLE, TN- ELIZABETHTOWN, KY-DAYTON, OH  
FRANKLIN, TN-CHATTANOOGA, TN- LEXINGTON, KY-CULLMAN, AL

PH* 1-800-737-0707	DWG. NO. PI-002
DATE:05/05/05	SHEET* 1 OF 1

12" [300mm] TO 36" [900mm]  
REINFORCED CONCRETE PIPE

SCALE: NTS