

TABULATED DIMENSIONS SINGLE OFFSET JOINT FOR STORM C443 JOINT

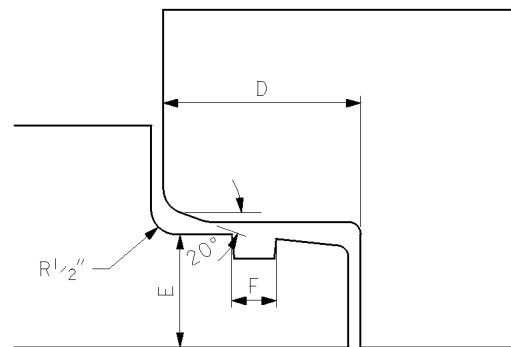

TABULATED DIMENSIONS O-RING RUBBER GASKET FOR ASTM C443 JOINT

PIPE DIA. SIZE IN [mm]	WALL THICKNESS A (WALL)	OUTSIDE DIAMETER B	C	D	E	F	APPROX. WEIGHT LB./FT	WATERWAY AREA SQ. FT.
42" [1050]	4 1/2 B	51	46.280	4"	2.07	1 3/16	700	9.62
48" [1200]	5 B	58 1/8	52.781	4"	2.07	1 3/16	890	12.57
54" [1350]	5 1/2 B	65	59.150	4 1/4"	2.07	1.00	1100	15.90
60" [1500]	6 3/4 C	73 1/2	63.880	4 3/4"	2.45	1 3/16	1435	19.64
66" [1650]	7 1/4 C	79	71.600	5"	2.92	1 3/16	1805	23.76
72" [1800]	7 3/4 C	87 1/2	78.100	5"	2.97	1 3/16	2015	28.22
84" [2100]	8 3/4 C	101 1/2	90.970	5"	3.56	1 1/4	2660	38.50

**GENERAL NOTES:**

1. PIPE IS MANUFACTURED IN ACCORDANCE WITH APPLICABLE SPECIFICATIONS WITH REINFORCING STEEL AS REQUIRED BY ASTM C-76 (LATEST REVISION): "STANDARD SPECIFICATION FOR REINFORCED CONCRETE CULVERT, STORM DRAIN, AND SEWER PIPE". GASKET JOINTS ARE IN ACCORDANCE WITH ASTM C-361 (LATEST REVISION): "STANDARD SPECIFICATION FOR REINFORCED CONCRETE LOW-HEAD PRESSURE PIPE" OR ASTM C-443 (LATEST REVISION): "STANDARD SPECIFICATION FOR JOINTS FOR CIRCULAR CONCRETE SEWER AND CONCRETE PIPE, USING RUBBER GASKETS".

2. FOR 60"-84" STORM PIPE: ALL PHYSICAL DIMENSIONS ARE THE SAME AS FOR O-RING PIPE EXCEPT THE GASKET GROOVE MAY BE OMITTED.

★  
**SHERMANDIXIE**  
 NASHVILLE, TN-KNOXVILLE, TN- ELIZABETHTOWN, KY-DAYTON, OH  
 FRANKLIN, TN-CHATTANOOGA, TN- LEXINGTON, KY-CULLMAN, AL

42" (1050mm) TO 84" (2100mm)  
 REINFORCED CONCRETE PIPE

SCALE: NTS

PH\* 1-800-737-0707

DWG. NO. PI-003

DATE:05/05/05

SHEET\* 1 OF 1